

Bioenergy from sludge and waste.

The biogas plant Watershap Veluwe in Apeldoorn in the Netherlands, is connected directly to a waste water treatment plant. In addition to sludge from the sewage treatment plant, blood, abattoir waste and food waste are also processed here. The total volume of these is approx. 240 m³ which is supplied to the plant daily by truck. Up to 1,400 kWh electrical energy can be generated.

The seepex pumps installed in the plant are used to convey sludges which can also contain solids such as shards of glass or small pieces of plastic, blood and fermentation substrate. They ensure that all these products stay "in suspension" during the most important process steps: when being conveyed from the sewage treatment plant to the biogas plant, and also from the heat exchanger to the post-fermenter.

Recently, the first pump on site was equipped with the "Smart Stator Technology" (SST) developed by seepex. This technology increases the pump's reliability and cost-effectiveness – while reducing maintenance costs to a minimum.

Key facts

- Reliable continuous operation
- Pumping of products containing solids and abrasive products
- Low maintenance
- Quick and easy maintenance when required
- Lower servicing costs
- Longer component life

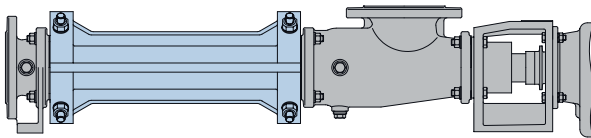

Installed Pump Type

- Range BN with Smart Stator Technology (SST)



Two of five seepex BN range pumps at the Watershap biogas plant

And what can we get flowing for you? Your nearest contact:

Or visit www.seepex.com